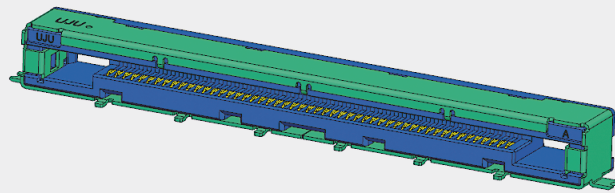

FPC/FFC Connectors

(Display)

VENUS
Applications | Mobile device, Display, PC

- ▶ Low Voltage Differential Signaling(LVDS) connector
- ▶ Terminal deformation prevention structure
- ▶ Reverse insertion prevention structure
- ▶ Damage prevention structure by a cover

Code & Specification

Mating Size / Unit : (mm)

Product Code	Pitch (mm)	No. of Contacts	Width (mm)	Height (mm)	Length	Remark
IS050-C41B-C39-C	0.50	41	3.75	3.85	32.85	-
IS050-C51B-C39-C	0.50	51	3.75	3.85	37.85	-

Current Rating	Contact Resistance	Insulation Resistance	Dielectric Strength	Temperature Range
AWG #30, #32, #36 0.8A/Pin	80mΩ [Max.]	100MΩ [Min.]	AC 500V	-25°C ~ 85°C

FPC/FFC Connectors (Display)

VENUS
Applications | Mobile device, Display, PC

Product Specification

Ratings	Rated current	AWG #30 , #32 , #36 0.8A/Pin	Operating temperature range	-25°C to +85°C 1	Storage temperature range	15°C to 35°C (With packing)
	Rated voltage	AC , DC 200V	Operating humidity range	25% to 95% RH 2)	Storage humidity range	65%RH

1) Including terminal temperature rise.

2) Storage area is to be free of corrosive gases and dew formation.

Items	Specifications	Conditions
1. Contact resistance	80mΩ [Max.]	- Test Current : 10μA - Open voltage : 20mV max.
2. Insulation resistance	100MΩ Min.	Test voltage : DC 100V 1min±5sec (Based upon MIL-STD-202 Method302 condition B)
3. Withstanding voltage	No flashover or dielectric breakdown	- Test voltage : AC 500V - Electrification time : 1 min/5 sec (Based upon MIL-STD-202 Method 301)
4. Insertion Force	10.2kgf [Max.]	Insert the wafer at a rate of 25±3 mm/min.
5. Withdrawal Force	After 10 test , 0.52kgf [Min.]	Withdraw the wafer at a rate of 25±3 mm/min.
6. Durability	Contact resistance : 80mΩ Max	30 cycle of total insertion and withdrawal operation.
7. Vibration	Contact resistance : 80mΩ Max	- Vibration frequency range : 10~55Hz - Total amplitude : 1.5mm - Sweep ration : 10-55-10Hz / Approx 1min. - Duration : 2h each (6h in total)
8. Shock resistance	Discontinuity : 1.0 microsec. MAX.	- Acceleration : 50G (490 $\frac{m}{s^2}$) - Duration : 11ms - Number of shocks : 3 both axial directions, 3 times each, 18 times in total
9. Humidity	- Contact resistance : 80mΩ Max - Insulation resistance : 50MΩ Min	- Test current : 100mA - Detection level of text current disconnection : 1μs Temperature : 40°C±2°C Humidity : 90% ~ 95% Duration : 96hr
10. Temperature cycle	- Contact resistance : 80mΩ Max - Insulation resistance : 50MΩ Min	- 40±3(°C) : 30 minutes → +85±2(°C) : 30 minutes, 96 cycles

 11. Solder heat resistance
 Visual inspection : Connector shall meet the design and dimensional requirement3.s of each drawings.

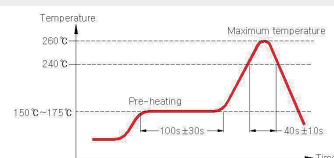
 Reflow condition.
(Refer to Reflow)

Materials / Finish

Part	Materials	Finish	UL Regulation
Base	LCP	Black	UL94V-0
Terminal	Phosphor Bronze	Au , Ni plated	-
Cover	Stainless Steel	Sn , Ni plated	-

FPC/FFC Connectors (Display)

VENUS

Applications | Mobile device, Display, PC

Product Drawing

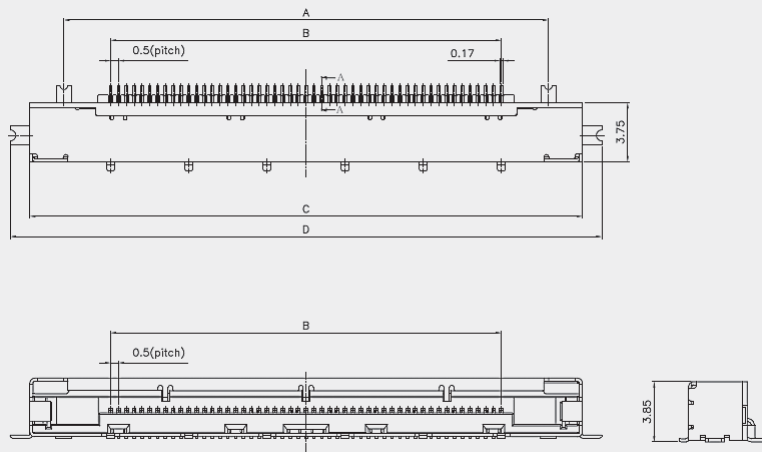
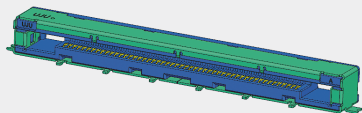

Recommended PCB , Metal Mask Layout

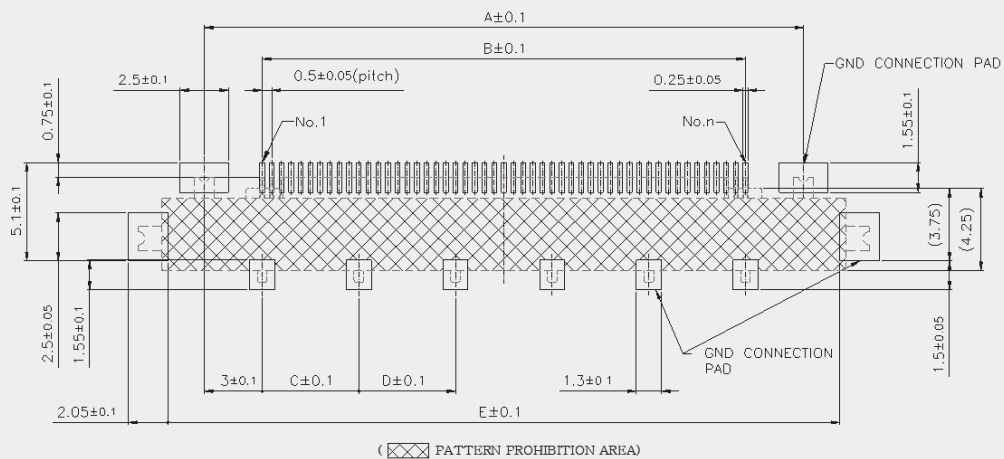

Mating Size / Unit : (mm)

Product No.	No. of Contacts	A	B	C	D
IS050-C41B-C39-C	41	26.00	20.0	30.35	32.85
IS050-C51B-C39-C	51	31.00	25.00	35.35	37.85