

FPC/FFC Connectors

(Display, LED Power)

FFC 1.0 Pitch 8PIN 4.6H

Applications | Mobile device, Display, PC

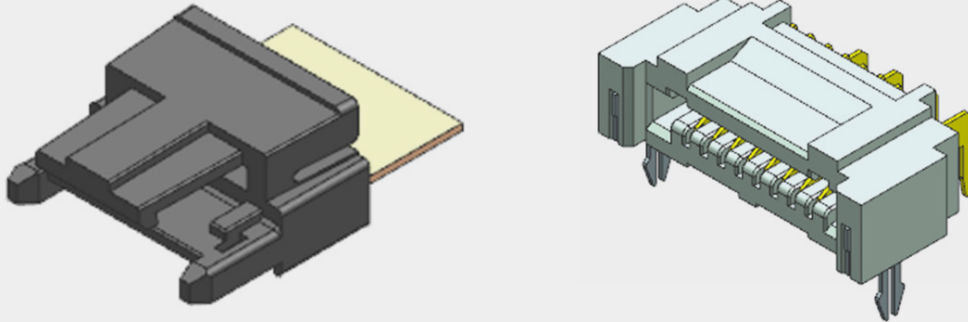

- ▶ 1.0mm Pitch, 6.2mm Height, Horizontal type connector
- ▶ Applicable for FFC thickness is 0.40±0.03mm

Code & Specification

Mating Size / Unit : (mm)

Product Code	Pitch (mm)	No. of Contacts	Width (mm)	Height (mm)	Length	Remark
Housing : HS100-L08N-N62 HS100-L08N-N62-A	1.00	8	10.95	6.20	11.30	-
DIP Wafer : IS100-L08T-C46 IS100-L08T-C46-A	1.00	8	10.27	4.60	14.90	-
SMD Wafer : IS100-L08T-C46-B IS100-L08T-C46-C IS100-L08B-C46 IS100-L08B-C46-A	1.00	8	7.80	4.40	16.35	-
Housing : HS100-L14N-N62 HS100-L14N-N62-A	1.00	14	10.95	6.20	17.30	-
DIP Wafer : IS100-L14T-C46 IS100-L14T-C46-A	1.00	14	10.27	4.60	20.90	-
SMD Wafer : IS100-L08T-C46-B IS100-L08T-C46-C	1.00	14	7.80	4.40	22.35	-

Current Rating	Contact Resistance	Withstanding Voltage	Temperature Range
1.0A Max.	50mΩ [Max.]	AC 500V	-35°C ~ 85°C

FPC/FFC Connectors

(Display, LED Power)

FFC 1.0 Pitch 8PIN 4.6H

Applications | Mobile device, Display, PC

Product Specification

Ratings	Rated current	1.0A Max. / contact	Operating temperature range	-35°C to +85°C	Storage temperature range	15°C to 35°C
	Rated voltage	150V AC, DC	Operating humidity range	85%RH 2	Storage humidity range	65%RH

1) Including terminal temperature rise.

2) Storage area is to be free of corrosive gases and dew formation.

Applicable FFC Specification T=0.4±0.03mm

Items	Specifications	Conditions
1. Contact resistance	50mΩ Max. / contact	Closed circuit Current : 10mA. Opened circuit voltage : 20mV
2. Insulation resistance	50MΩ Min.	Test voltage : 500V D.C.
3. Withstanding voltage	No flashover or dielectric breakdown	AC 500V for 1minute
4. Insertion Force	4.0kgf [Max.]	FFC shall be insert at a speed of 25mm/min and measured the insertion force.
5. Durability	No damage or mechanical defect Contact resistance : 50mΩ Max. / contact	Number of cycles : 30 cycles.
6. Vibration	No damage or mechanical defect Contact resistance : 500mΩ Max. / contact	Amplitude: 1.5mm Test current: DC 100mA Frequency: 10-55-10Hz/Min Duration : XYZ axis 2h each (6h in total)
7. Humidity	No damage or mechanical defect Contact resistance : 50mΩ Max. / contact Insulation Resistance : 50MΩ Min.	Temperature : 40°C±2°C Humidity : 90% ~ 95% Duration : 96hr
8. Solder heat resistance	Visual inspection : Connector shall meet the design and dimensional requirements of each drawings.	Reflow : Refer to the recommended reflow condition.

Materials / Finish

Part	Materials	Finish	UL Regulation
Housing Base	PA66	Natural	UL94V-0
Wafer Base	LCP	Black	UL94V-0
Contact Terminal - A	Phosphor Bronze	Sn over Nickel	-
Contact Terminal - B	Phosphor Bronze	Sn over Nickel	-
Fitting Nail	Phosphor Bronze	Sn over Nickel	-

FPC/FFC Connectors

(Display, LED Power)

FFC 1.0 Pitch 8PIN 4.6H

Applications | Mobile device, Display, PC

Product Drawing

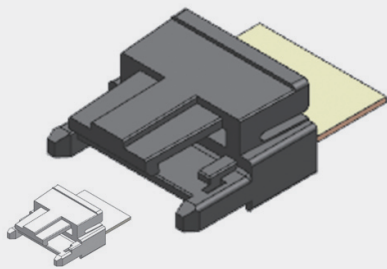

Housing

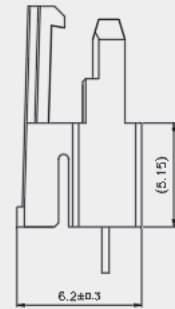
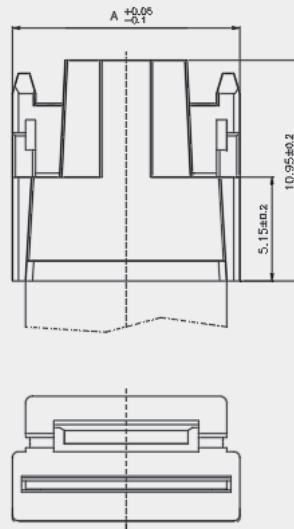

Recommended FPC Dimensions

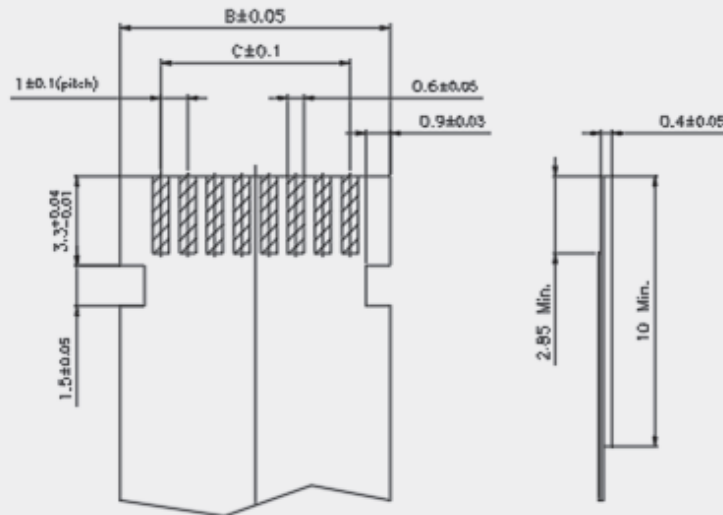

Mating Size / Unit : (mm)

Product No.	No. of Contacts	A	B	C
HS100-L08N-N62-A	8	11.30	10.00	7.00

FPC/FFC Connectors (Display, LED Power)

FFC 1.0 Pitch 8PIN 4.6H

Applications | Mobile device, Display, PC

Product Drawing

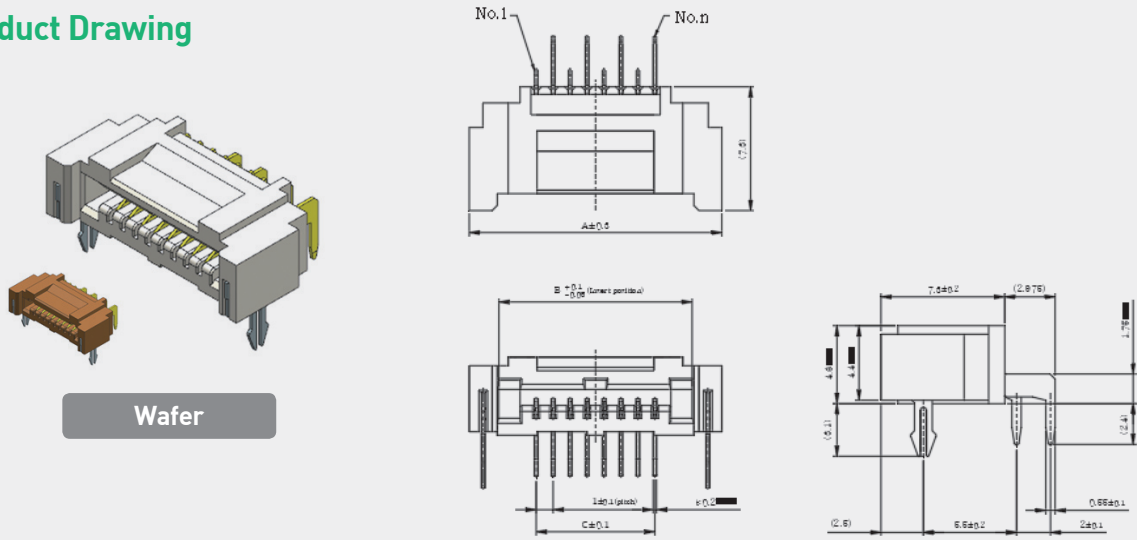

Recommended PCB, Metal Mask Layout

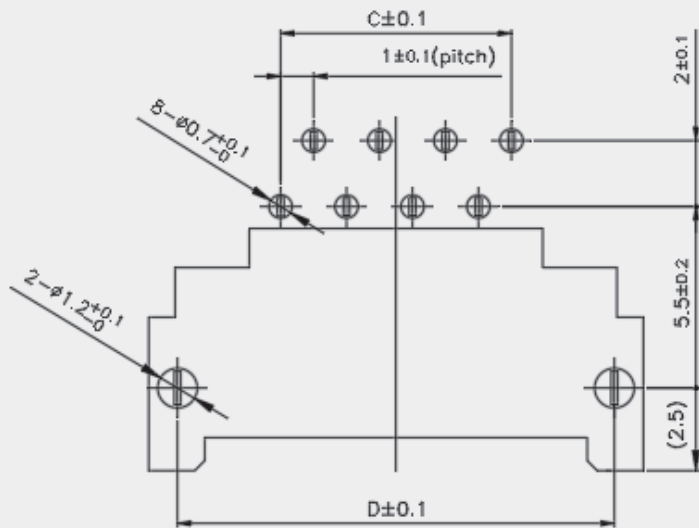

Recommended PCB Dimensions

Mating Size / Unit : (mm)

Product No.	No. of Contacts	A	B	C	D
IS100-L08T-C46-A	8	14.90	11.40	7.00	13.25

FPC/FFC Connectors

(Display, LED Power)

FFC 1.0 Pitch 8PIN 4.6H

Applications | Mobile device, Display, PC

Product Drawing

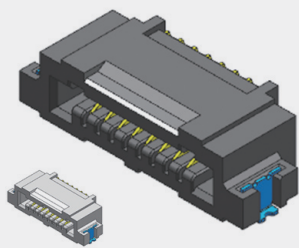

Wafer

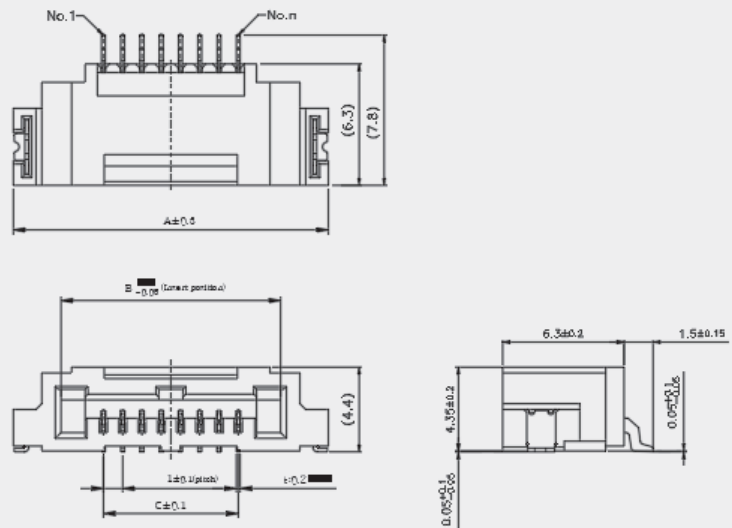

Recommended PCB, Metal Mask Layout

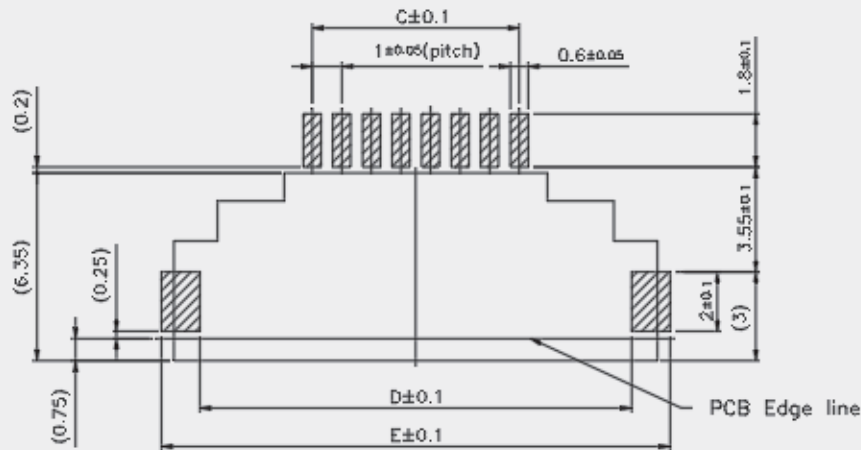

Recommended PCB Dimensions

Mating Size / Unit : (mm)

Product No.	No. of Contacts	A	B	C	D	E
IS100-L08B-C46-A	8	16.35	11.40	7.00	14.60	17.20