

TPA LOCKING POSITION

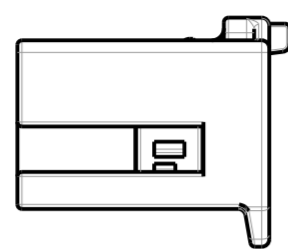

1st LOCK POSITION
(DELIVERY SHAPE FOR CUSTOMER)

2nd LOCK POSITION

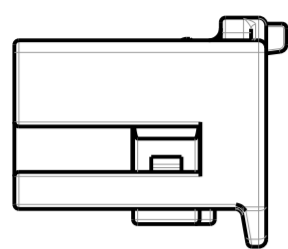
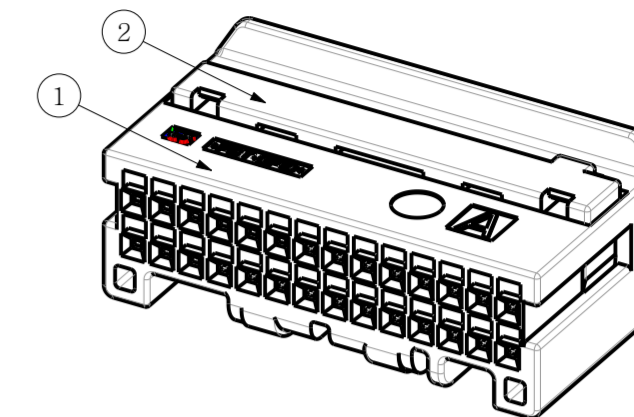
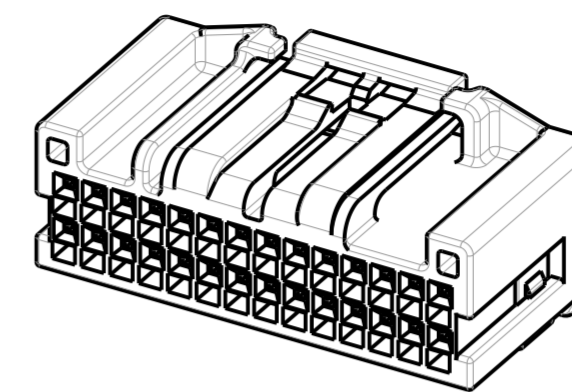
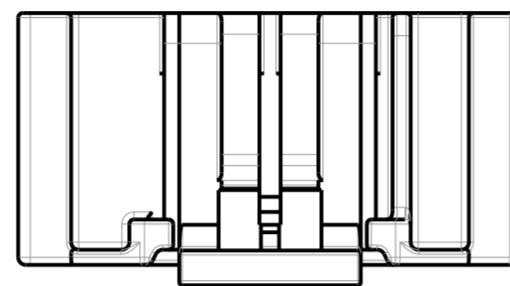

ISO VIEW

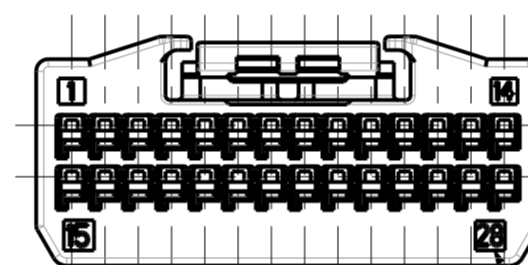
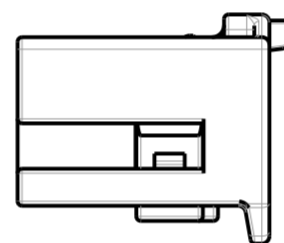
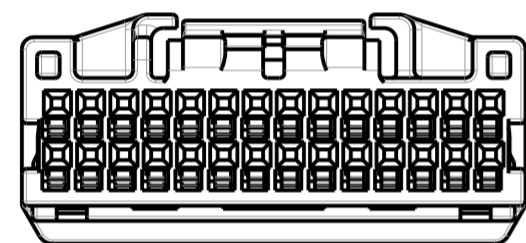

CIRCUIT NO.

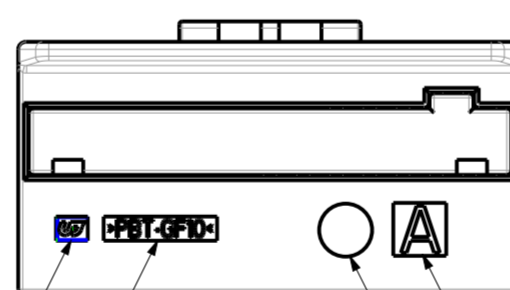
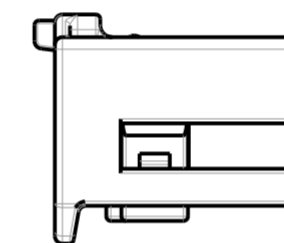

UJU LOGO
RECYCLE MARK

CAVITY NO.
DATE MARK (MM/YY)

NOTE

1. GENERAL TOLERANCE : SEE TABLE TOLERANCE
2. DELIVERY CONDITION : TPA FIRST LOCK POSITION
3. HSG DESCRIPTION : SEE TABLE-1
4. APPLICABLE RECEPTACLE TERMINAL : SEE TABLE-2
5. REFERENCE MATING CONNECTOR IS KH2100058

TOLERANCE

10MAX	30MAX	50MAX	70MAX	100MAX	120MAX	250MAX	250VR	ANGLE
± 0.15	± 0.20	± 0.30	± 0.40	± 0.50	± 0.75	± 0.9	± 1.4	± 0.5°

TABLE-1

DESCRIPTION	PART NO.	CODE	MATERIAL	FINISH/COLOR
025_II_28F_ASSY_NR	KH2100055-10	-	PBT-GF10	NATURAL
025_II_28F_ASSY_BK	KH2100055-20	-	PBT-GF10	BLACK

TABLE-2

DESCRIPTION	PART NO.	WIRE RANGE	MATERIAL	FINISH
025_II_FEMALE_TERMINAL(M)	KH2000016-21	0.3 ~ 0.5 SQ	COPPER ALLOY	PRE-TIN

NO.	DESCRIPTION	PART NO.	CODE	MATERIAL	FINISH/COLOR	Q'TY
2	025_II_28F_TPA_GN	KM2100057-70	-	PBT-GF10	GREEN	1
1	025_II_28F_HSG_NR	KM2100056-10	-	PBT-GF10	NATURAL	1
	025_II_28F_HSG_BK	KM2100056-20	-	PBT-GF10	BLACK	1

ASSY DESCRIPTION	ASSY PART NO.	CODE
025_II_28F_ASSY_NR	KH2100055-10	-
025_II_28F_ASSY_BK	KH2100055-20	-

REV	REVISION RECORD	DATE	DRWN	CHKD	APVD
1	ENGINEERING CONTROLLED	17.JUN'21	SJ	KH	CY

TOLERANCES UNLESS OTHERWISE SPECIFIED		UNIT MM	DRWN SJ.LEE	(주)우주일렉트로닉스 UJU Electronics co.,Ltd.			
THIRD ANGLE PROJECTION		MATERIAL	CHKD KH.PARK				
PRODUCT SPEC		FINISH/COLOR	APVD CY.CHOI				
APPLICATION SPEC		WEIGHT	NAME		025_II_28F_ASSY		
RESTRICTED TO		LOC	DRAWING		DRAWING NO. KH2100055		
SIZE		SCALE	SHEET		REV		
A2		2:1	1 OF 1		1		