

REV	REVISION RECORD	DATE	DRWN	CHKD	APVD
A	RELEASED (RD-2022-038)	21 APR '22	JK	SJ	CY
B	CHANGED (RD-2022-103)	29 JUL '22	JK	SJ	CY

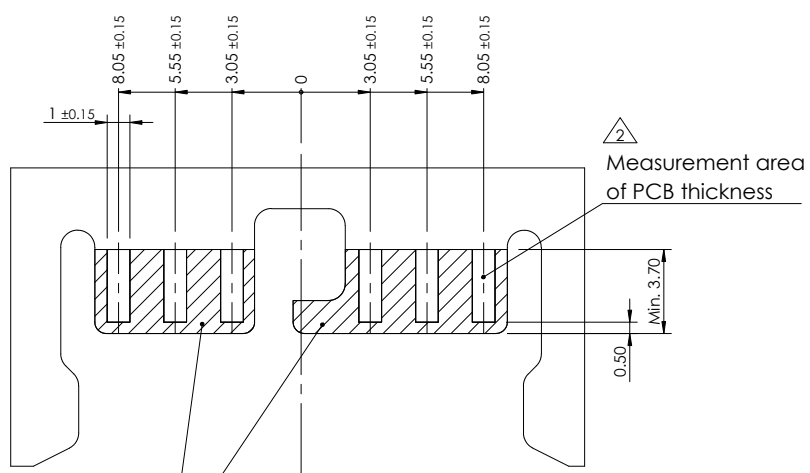

Not allow the pattern in this area except specified.  
지정되지않은 통패턴 비 허용 영역 (PCB TOP & BOTTOM)

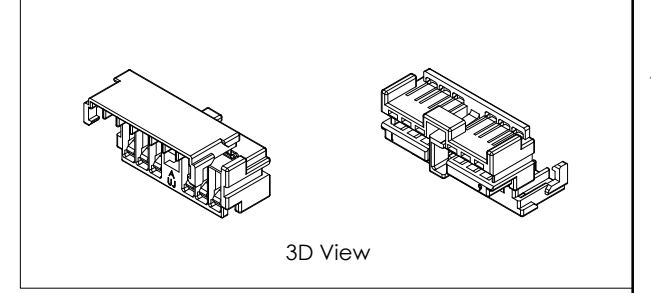
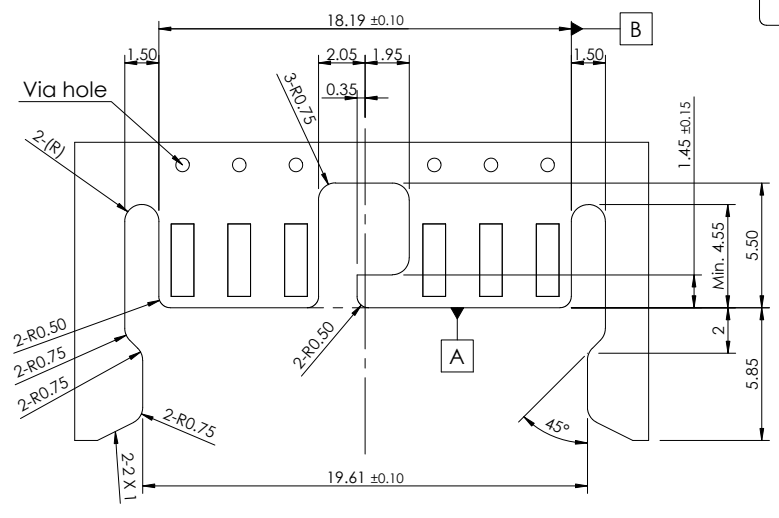
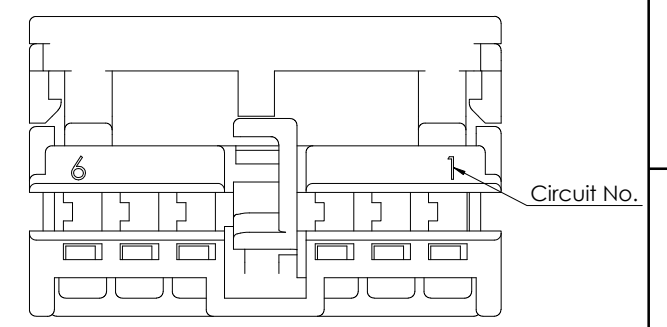
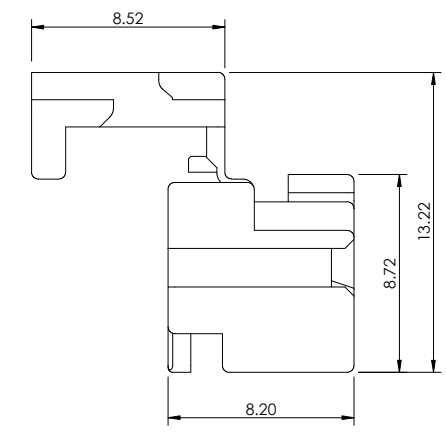
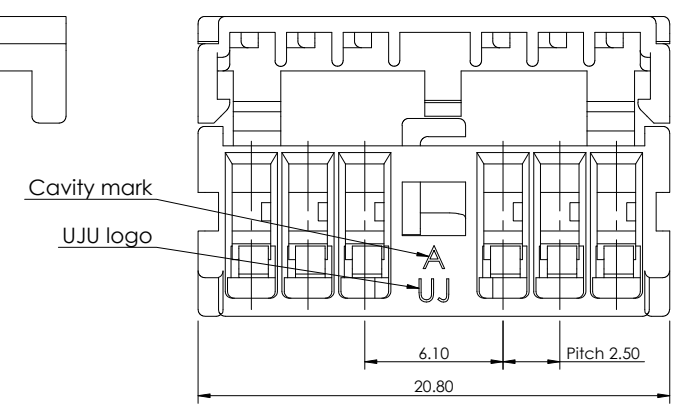
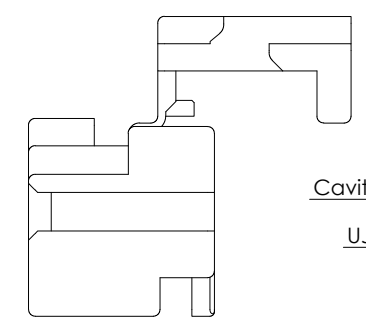
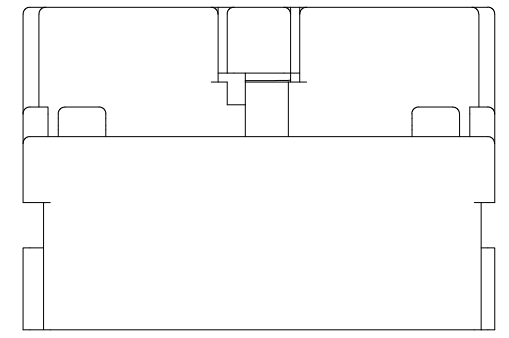

-Note 2. (PCB)-

- General tolerance : ±0.2
- Thickness : 1.60 ±0.16
- Finish : Same as terminal plating  
Ex) Sn (HASL) ↔ Sn, Au ↔ Au
- Recommendation : Apply a via hole for connect both sides.  
- PCB material : FR4  
- Pad material : Cu 17 μm  
- Plating : Sn 0.4~0.5 μm
- Reference PCB specification used for UJU validations
- Consult UJU for details of specifications.

-Note 1. (Housing)-

- General Tolerance : ±0.3
- HSG Description : See Table 1.
- Burr Max.0.3
- No crack
- All letters shall be clear and legible.
- Packing : Polybag
- Applicable receptacle : KH2000008 (PCB\_Slot\_F\_V\_TML)  
- Material : Copper alloy

Table 1.

Description	Part No.	Material	Finish / Color
PCB_Slot_6F_V_HSG_GR	KH2000012-30	PBT-GF10	ⓑ Gray
PCB_Slot_6F_V_HSG_NR	KH2000012-10		Natural

TOLERANCES UNLESS OTHERWISE SPECIFIED		UNIT MM		DRWN JK. HWANG	 (주)우주 일렉트로닉스 UJU Electronics co.,Ltd.					
0	±	THIRD ANGLE PROJECTION	APVD CY. CHOI	NAME						
0.0	±		MATERIAL	SEE TABLE	PCB_Slot_6F_V_HSG					
0.00	±		FINISH/COLOR	SEE TABLE						
0.000	±	PRODUCT SPEC	APPLICATION SPEC	WEIGHT	CUSTOMER DRAWING	DRAWING NO				
0.0000	±					KH2000012				
ANGLES	±				LOC	RESTRICTED TO	SIZE	SCALE	SHEET	REV
							A3	3:1	1 of 1	B