

REV	REVISION RECORD	DATE	DRWN	CHKD	APVD
A	RELEASED (RD-2022-030)	07 MAR '22	JK	SJ	CY
B	CHANGED (RD-2022-103)	29 JUL '22	JK	SJ	CY

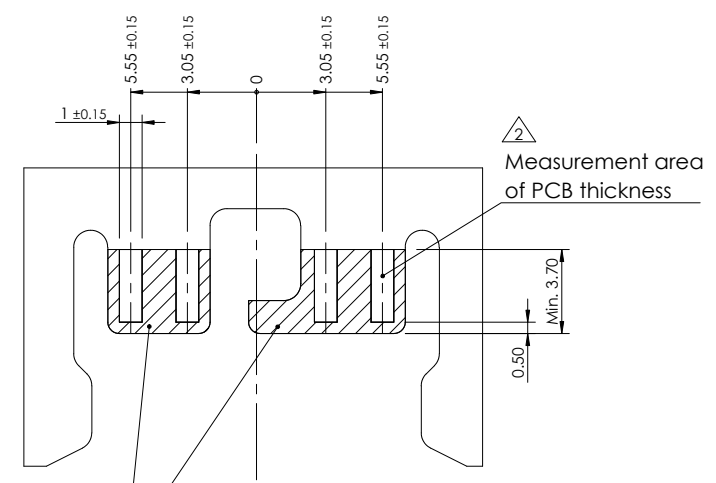

Not allow the pattern in this area except specified.
지정되지 않은 동패턴 비 허용 영역 (PCB TOP & BOTTOM)

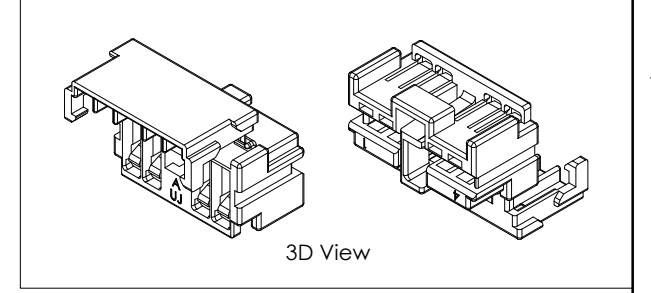
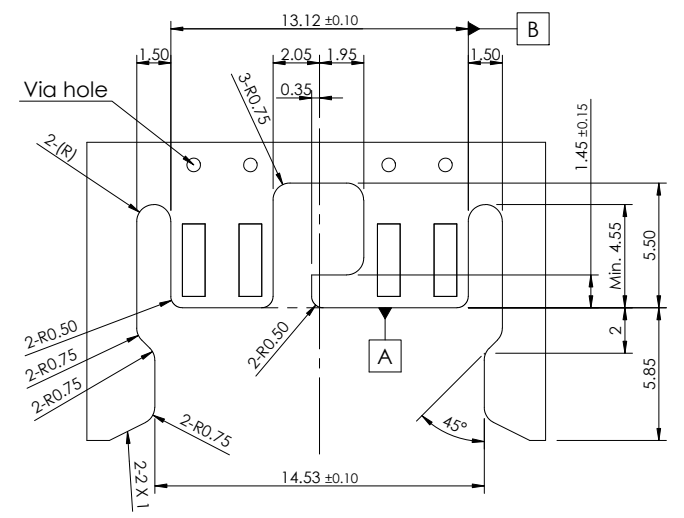
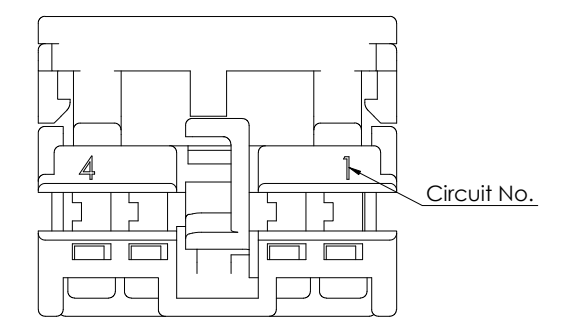
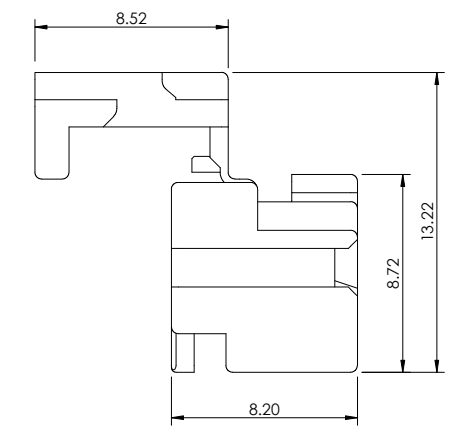
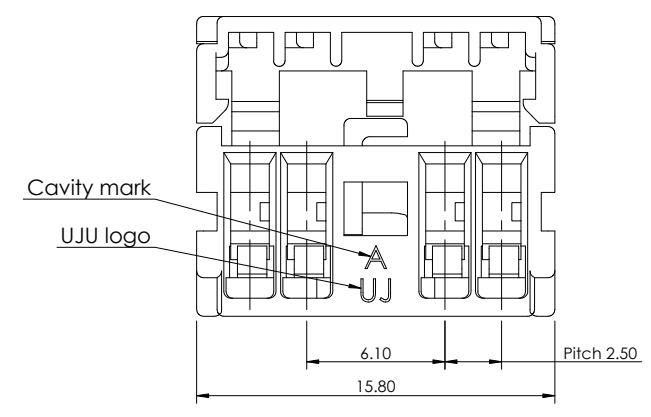
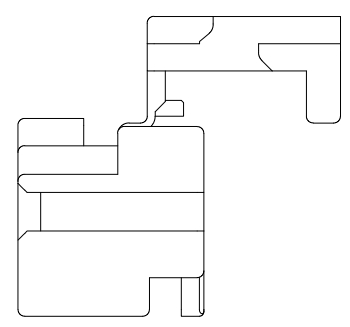
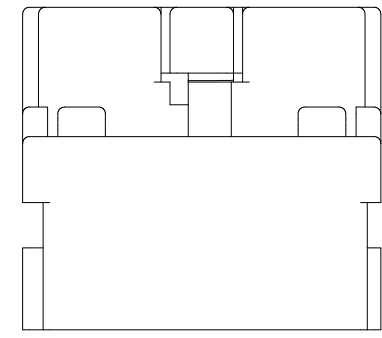

-Note 2. (PCB)-

- General tolerance : ±0.2
- Thickness : 1.60 ±0.16
- Finish : Same as terminal plating
Ex) Sn (HASL) ↔ Sn, Au ↔ Au
- Recommendation : Apply a via hole for connect both sides.
- PCB material : FR4
- Pad material : Cu 17 μm
- Plating : Sn 0.4~0.5 μm
- Reference PCB specification used for UJU validations
- Consult UJU for details of specifications.

-Note 1. (Housing)-

- General Tolerance : ±0.3
- HSG Description : See Table 1.
- Burr Max.0.3
- No crack
- All letters shall be clear and legible.
- Packing : Polybag
- Applicable receptacle : KH2000008 (PCB_Slot_F_V_TML)
- Material : Copper alloy

Table 1.

Description	Part No.	Material	Finish / Color
PCB_Slot_4F_V_HSG_GR	KH2000011-30	PBT-GF10	Ⓟ Gray
PCB_Slot_4F_V_HSG_NR	KH2000011-10		Natural

TOLERANCES UNLESS OTHERWISE SPECIFIED		UNIT MM		DRWN JK. HWANG	
0	±	THIRD ANGLE PROJECTION		CHKD SJ. LEE	
0.0	±			APVD CY. CHOI	
0.00	±			MATERIAL SEE TABLE	
0.000	±	FINISH/COLOR SEE TABLE		NAME PCB_Slot_4F_V_HSG	
0.0000	±	WEIGHT		CUSTOMER DRAWING KH2000011	
ANGLES	±	APPLICATION SPEC		DRAWING NO KH2000011	
PRODUCT SPEC				LOC RESTRICTED TO	
				SIZE A3	
				SCALE 3:1	
				SHEET 1 of 1	
				REV B	

