

REV	REVISION RECORD	DATE	DRWN	CHKD	APVD
A	RELEASED (RD-2022-038)	21 APR '22	JK	SJ	CY
B	CHANGED (RD-2022-103)	29 JUL '22	JK	SJ	CY

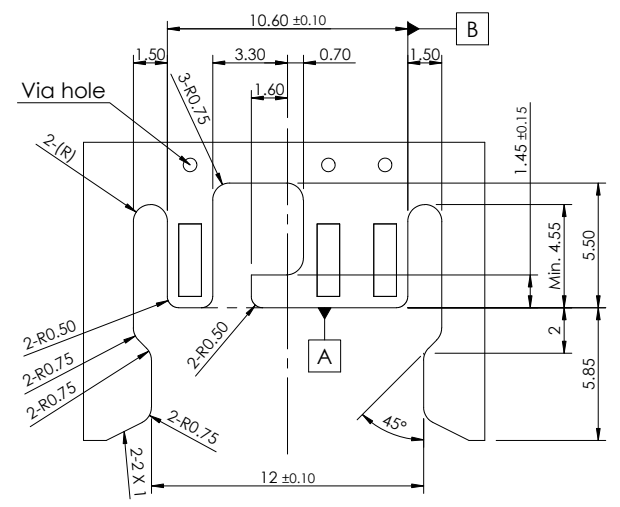
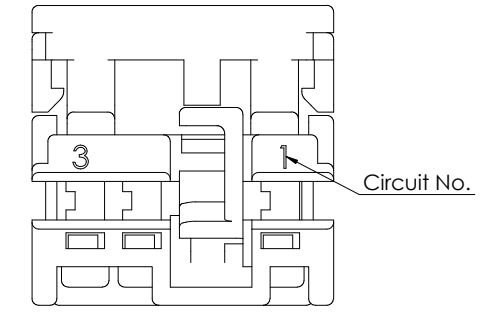
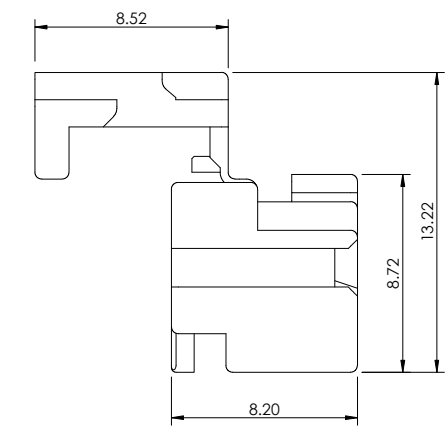
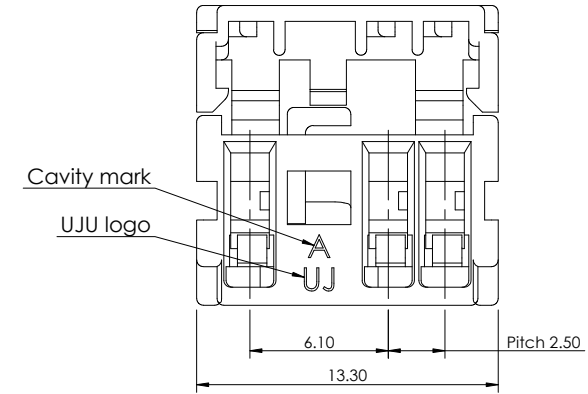
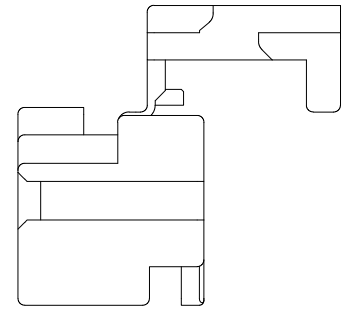
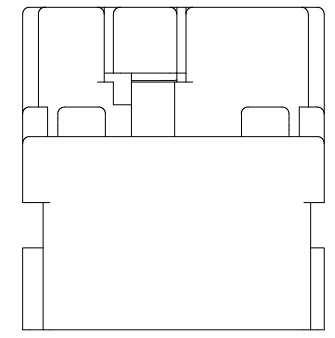
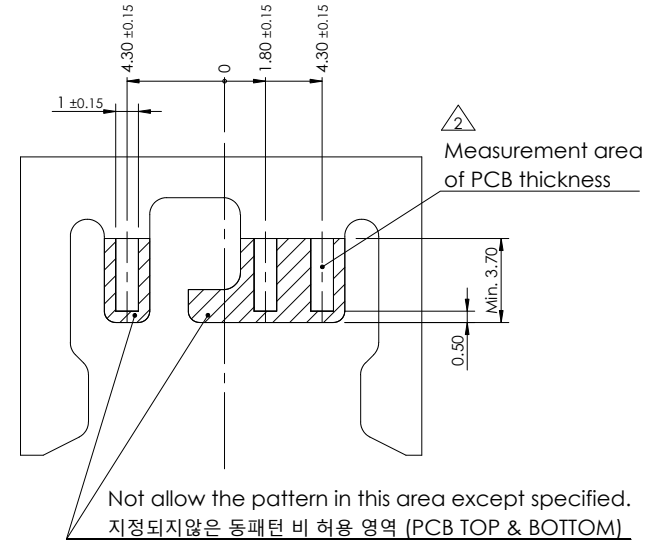
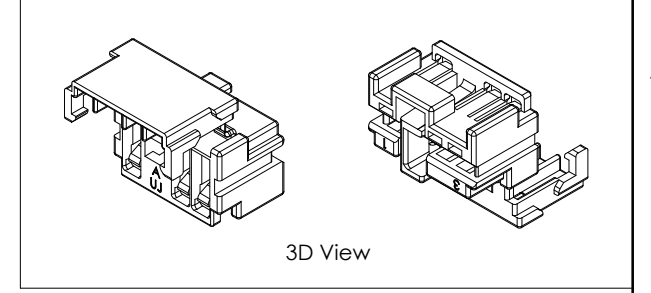

- Note 2. (PCB)-
1. General tolerance : ±0.2
  2. Thickness : 1.60 ± 0.16
  3. Finish : Same as terminal plating  
Ex) Sn (HASL) ↔ Sn, Au ↔ Au
  4. Recommendation : Apply a via hole for connect both sides.  
- PCB material : FR4  
- Pad material : Cu 17 μm  
- Plating : Sn 0.4~0.5 μm
  5. Reference PCB specification used for UJU validations
  6. Consult UJU for details of specifications.

- Note 1. (Housing)-
1. General Tolerance : ±0.3
  2. HSG Description : See Table 1.
  3. Burr Max.0.3
  4. No crack
  5. All letters shall be clear and legible.
  6. Packing : Polybag
  7. Applicable receptacle : KH2000008 (PCB\_Slot\_F\_V\_TML)  
- Material : Copper alloy

Table 1.

Description	Part No.	Material	Finish / Color
PCB_Slot_3F_V_HSG_GR	KH2000010-30	PBT-GF10	Ⓟ Gray
PCB_Slot_3F_V_HSG_NR	KH2000010-10		Natural

TOLERANCES UNLESS OTHERWISE SPECIFIED		UNIT MM		DRWN JK. HWANG	
0	±	THIRD ANGLE PROJECTION		CHKD SJ. LEE	
0.0	±			APVD CY. CHOI	
0.00	±			NAME PCB_Slot_3F_V_HSG	
0.000	±	MATERIAL SEE TABLE		CUSTOMER DRAWING KH2000010	
0.0000	±	FINISH/COLOR SEE TABLE		DRAWING NO. KH2000010	
ANGLES	±	WEIGHT		DRAWING NO. KH2000010	
PRODUCT SPEC	APPLICATION SPEC	LOC RESTRICTED TO		DRAWING NO. KH2000010	
		SIZE		SHEET	
		A3		1 of 1	
		SCALE		REV	
		3:1		B	