

REV	REVISION RECORD	DATE	DRWN	CHKD	APVD
A	RELEASED (RD-2020-152)	12 NOV '20	JK	KH	CY
B	CHANGED (RD-2020-156)	18 NOV '20	JK	KH	CY

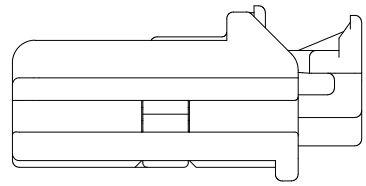

TPA 2nd. lock position

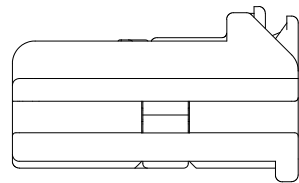

CPA 2nd. lock position

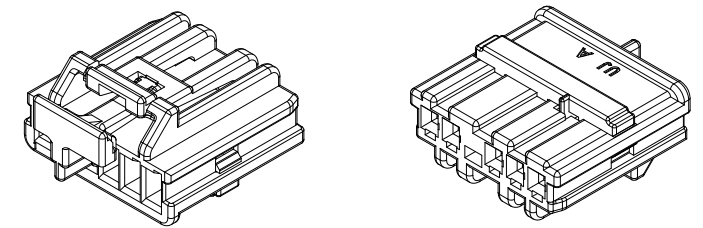
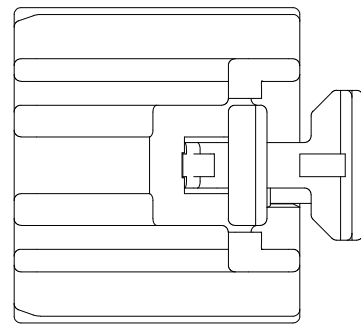

3D View

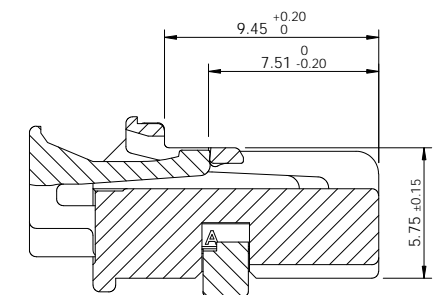
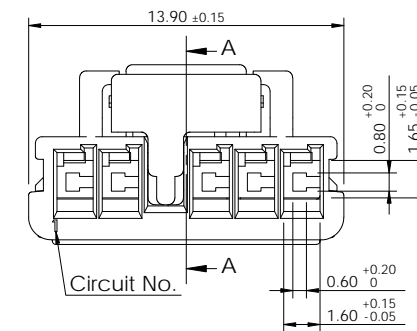
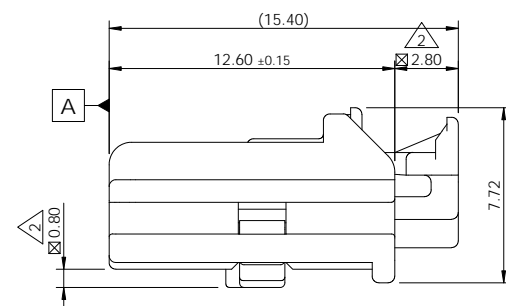
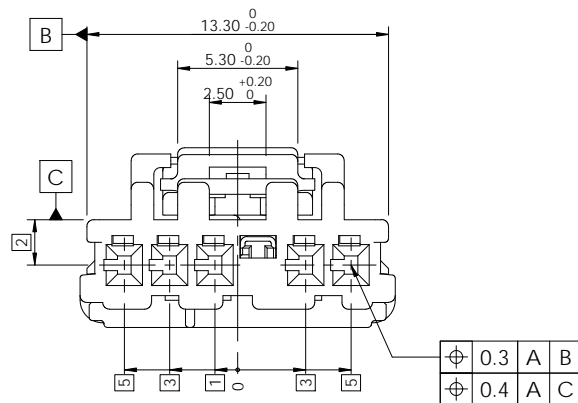

Section A-A

Code	Part No.	Description
D		020_D_C_5F_ASSY_BL_G
C	KH1910017-42	020_D_C_5F_ASSY_BR_G
B	KH1910017-21	020_D_C_5F_ASSY_BK_G
A	KH1910017-10	020_D_C_5F_ASSY_NR_G

-Note-

- General tolerance : Refer to DIN 16742 TG6 specification.
- Delivery condition : TPA/CPA 1st. lock position
- Burr Max.0.3
- No crack
- All letters shall be clear and legible.
- Packing : Tray
- Flammability : UL94-V0
- Applicable receptacle : KH1710007 (020\_D\_F\_TML\_G)
  - Material : Copper alloy
  - Wire size : 0.3mm<sup>2</sup> ~ 0.5mm<sup>2</sup>
- Matching part
  - KH1910038 (020\_D\_C\_SMT\_5M\_H\_ASSY\_G)
  - KH1910059 (020\_D\_C\_SMT\_5M\_V\_ASSY\_G)
- Avoid matching part
  - KH1710116 (020\_D\_SMT\_6M\_H\_ASSY\_G)
  - KH1810087 (020\_D\_SMT\_6M\_V\_ASSY\_G)

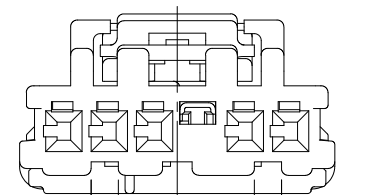

Code A (Natural)

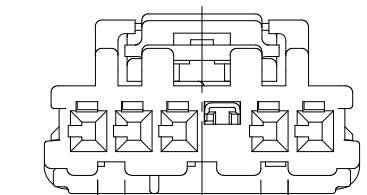

Code B (Black)

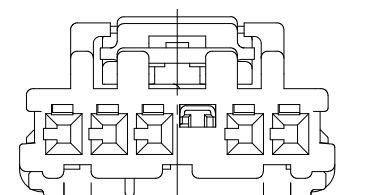
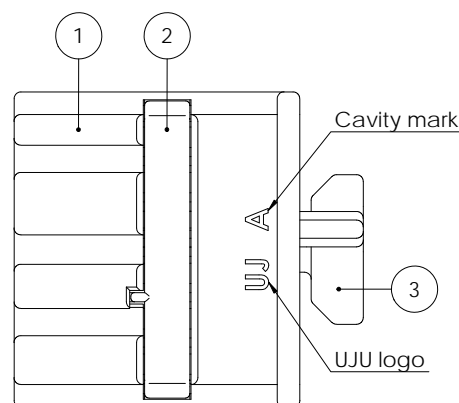

Code C (Brown)

On request, development is scheduled.

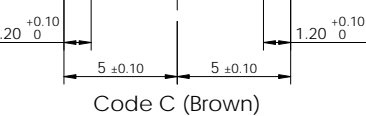

Code D (Blue)

No.	Description	Material	Finish / Color	Q'ty
3	020_D_C_3F_CPA_RE	PBT-GF30	Red	1 1 1 1
2	020_D_C_5F_TPA_GR	PBT-GF30	Gray	1 1 1 1
1	020_D_C_5F_HSG_BL	PBT-GF30	Blue	1 - - -
	020_D_C_5F_HSG_BR	PBT-GF30	Brown	- 1 - -
	020_D_C_5F_HSG_BK	PBT-GF30	Black	- - 1 -
	020_D_C_5F_HSG_NR	PBT-GF30	Natural	- - - 1

DRWN JK. HWANG	CHKD KH. PARK	APVD CY. CHOI	(주)우주 일렉트로닉스 UJU Electronics co.,Ltd.			
MATERIAL SEE TABLE		NAME 020_D_C_5F_ASSY_G		DRAWING NO KH1910017		
FINISH/COLOR SEE TABLE		CUSTOMER DRAWING		SIZE A3	SCALE 3:1	
WEIGHT		LOC	RESTRICTED TO	SHEET 1 of 1	REV B	