

REV	REVISION RECORD	DATE	DRWN	CHKD	APVD
A	RELEASED (RD-2020-160)	03 DEC '20	JK	KH	CY

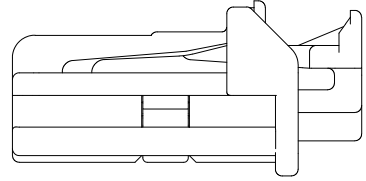

TPA 2nd. lock position

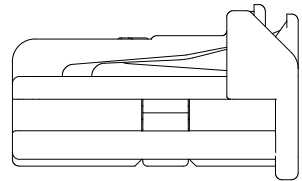

CPA 2nd. lock position

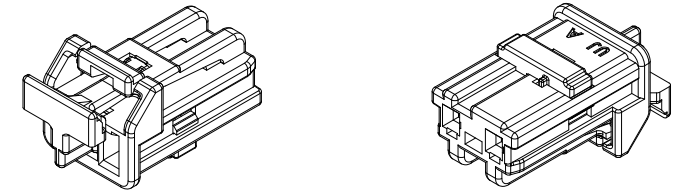
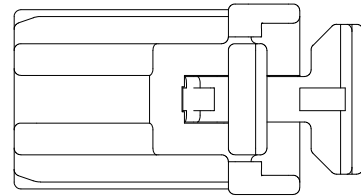

3D View

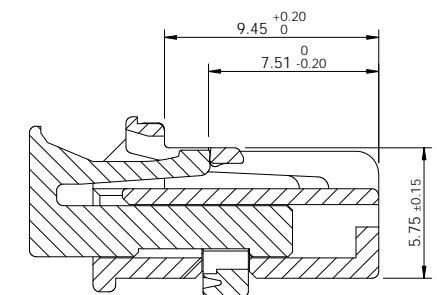
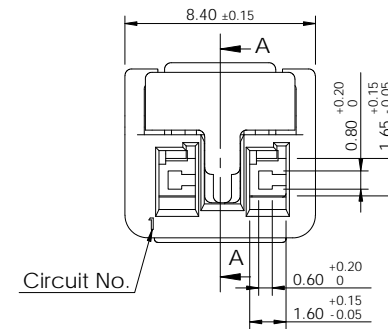
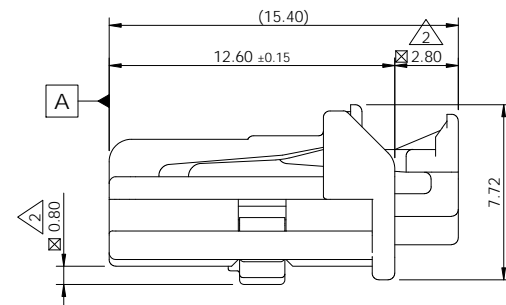
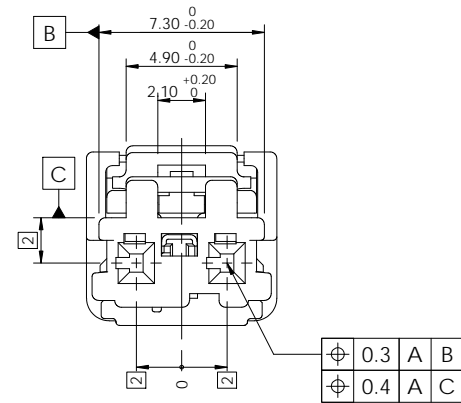

Section A-A

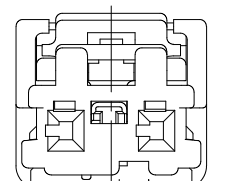

Code A (Natural)

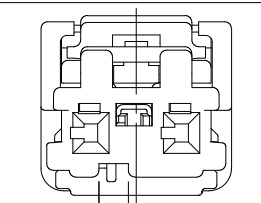

Code B (Black)

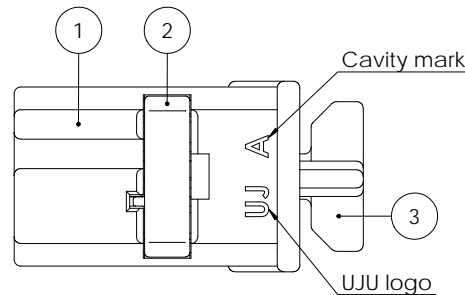

-Note-

- General tolerance : Refer to DIN 16742 TG6 specification.
- Delivery condition : TPA/CPA 1st. lock position
- Burr Max.0.3
- No crack
- All letters shall be clear and legible.
- Packing : Tray
- Flammability : UL94-V0
- Applicable receptacle : KH1700007 (020\_D\_F\_TML)
  - Material : Copper alloy
  - Wire size : 0.3mm<sup>2</sup> ~ 0.5mm<sup>2</sup>
- Matching part
  - KH1900035 (020\_D\_C\_SMT\_2M\_H\_ASSY)
  - KH1900056 (020\_D\_C\_SMT\_2M\_V\_ASSY)
- Avoid matching part
  - KH1700112 (020\_D\_SMT\_3M\_H\_ASSY)
  - KH1800081 (020\_D\_SMT\_3M\_V\_ASSY)

Code	Part No.	Description
B	KH1900009-21	020_D_C_2F_ASSY_BK
A	KH1900009-10	020_D_C_2F_ASSY_NR

No.	Description	Material	Finish / Color	1	1
3	020_D_C_2F_CPA_RE	PBT-GF30	Red	1	1
2	020_D_C_2F_TPA_GR	PBT-GF30	Gray	1	1
1	020_D_C_2F_HSG_BK	PBT-GF30	Black	1	-
	020_D_C_2F_HSG_NR	PBT-GF30	Natural	-	1

DRWN JK. HWANG	CHKD KH. PARK	APVD CY. CHOI	NAME		
MATERIAL SEE TABLE			020_D_C_2F_ASSY		
FINISH/COLOR SEE TABLE			CUSTOMER DRAWING		
WEIGHT			DRAWING NO KH1900009		
LOC	RESTRICTED TO	SIZE A3	SCALE 3:1	SHEET 1 of 1	REV A

TOLERANCES UNLESS OTHERWISE SPECIFIED	UNIT MM	THIRD ANGLE PROJECTION
0 ±		
0.0 ±		
0.00 ±		
0.000 ±		
0.0000 ±		
ANGLES ±		
PRODUCT SPEC	APPLICATION SPEC	