

SECTION A-A

(MAX. Ø8.0)

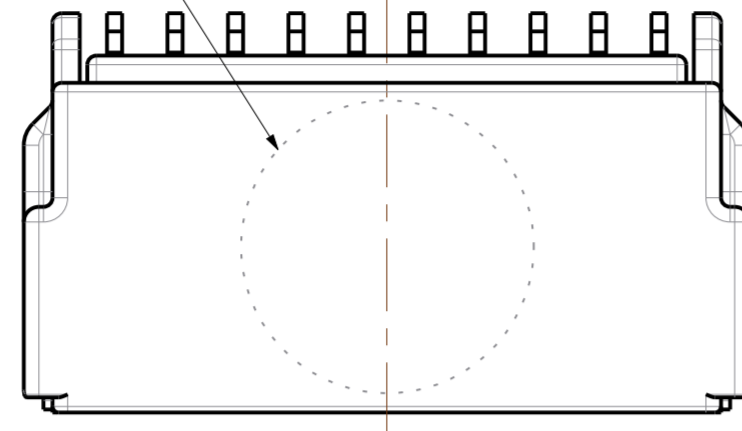

SEE DETAIL A

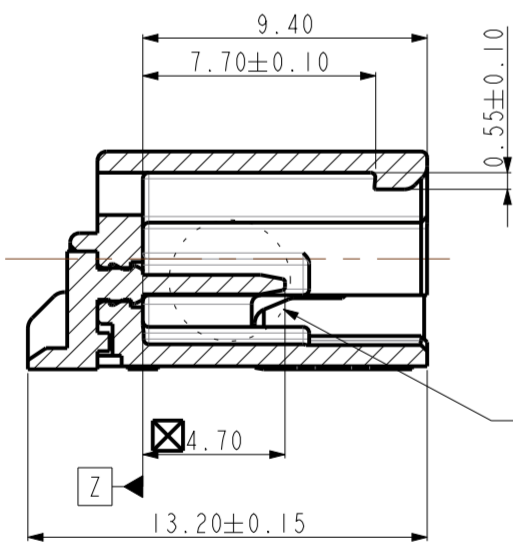
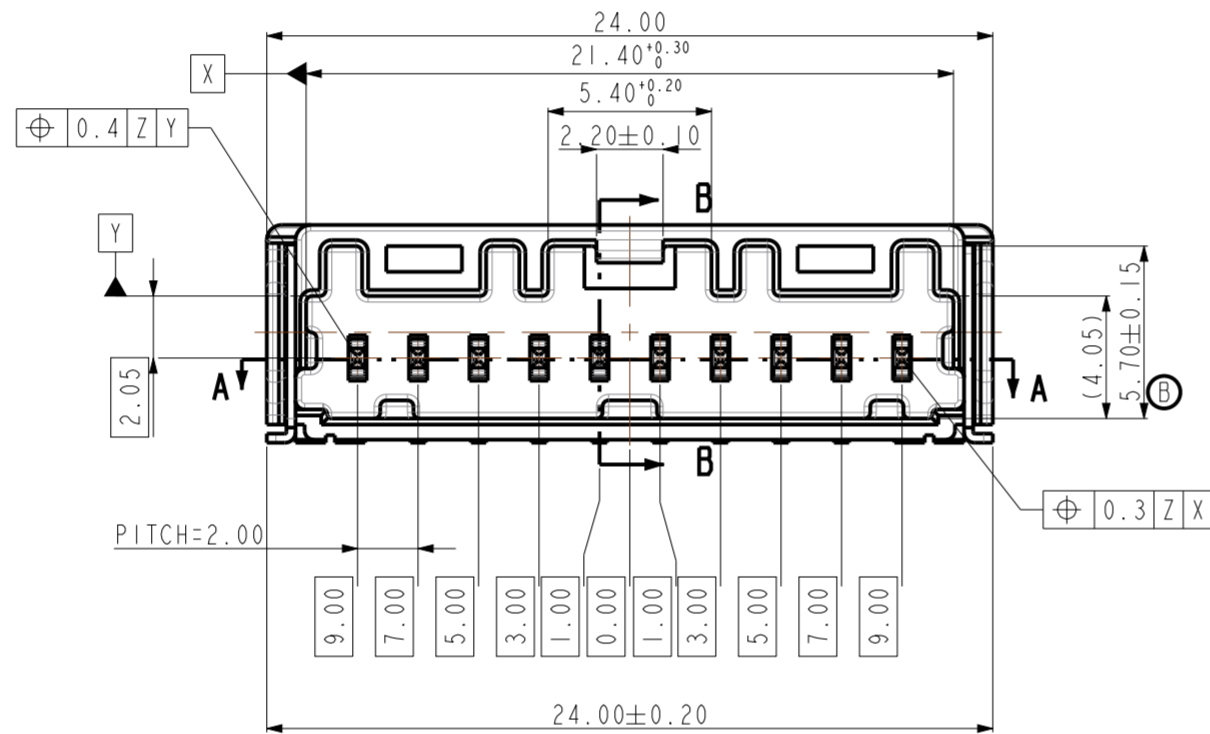
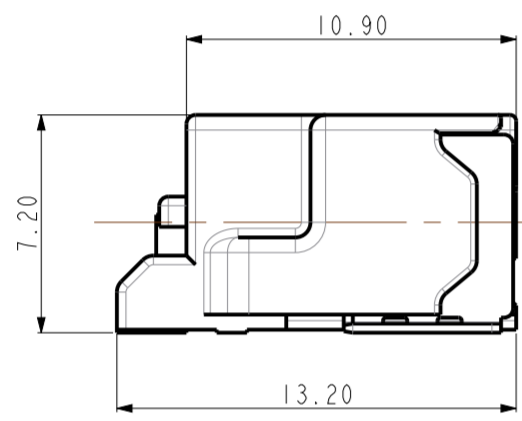

SECTION B-B

SEE DETAIL B

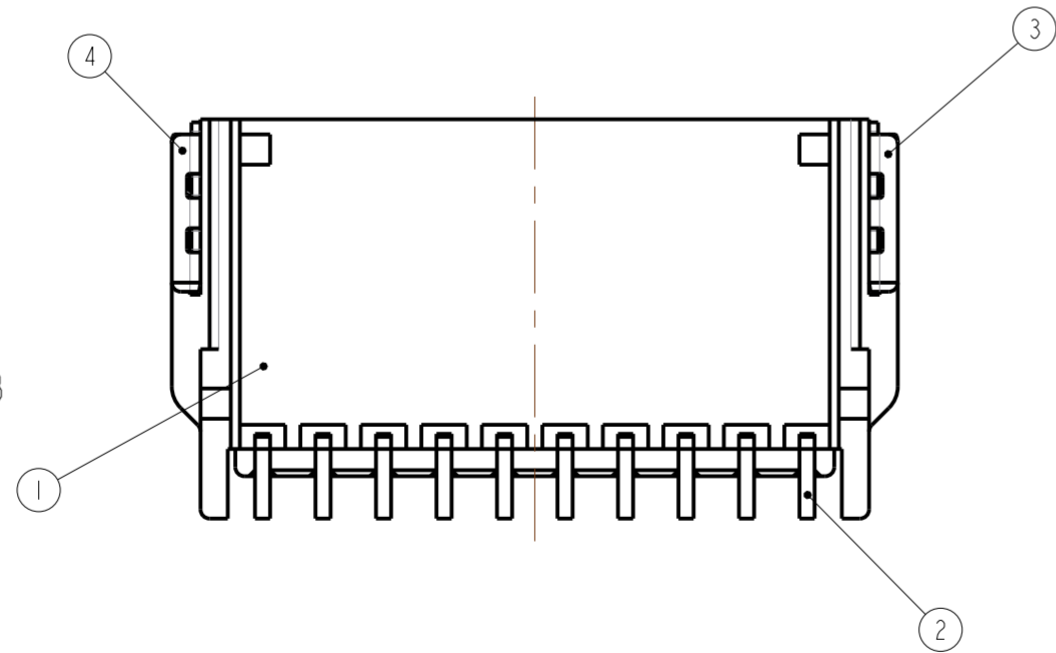

PCB PATTERN

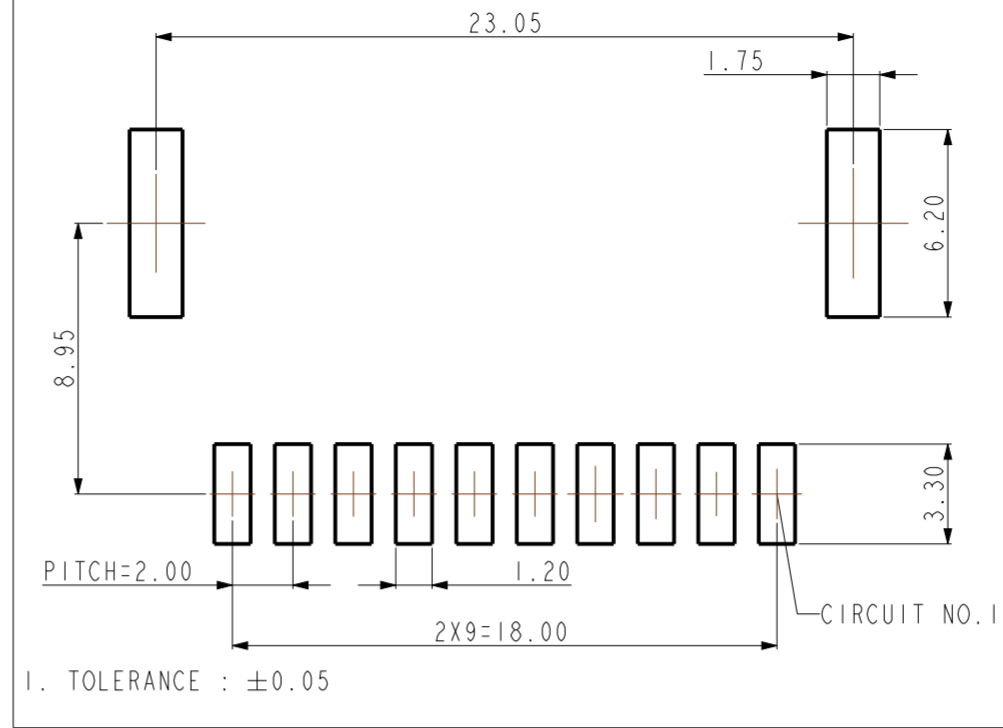

1. TOLERANCE : ±0.05

| REV | REVISION RECORD | DATE | DRWN | CHKD | APVD |
|-----|-----------------------|-----------|------|------|------|
| A | RELEASED | 21.JUN'19 | DR | KH | CY |
| B | REVISED (RD-2020-029) | 09.MAR'20 | DR | KH | CY |
| C | REVISED (RD-2020-140) | 23.OCT'20 | DR | KH | CY |

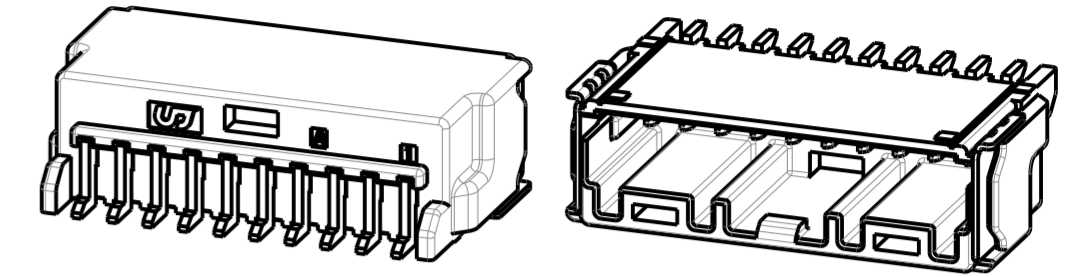

ISO VIEW

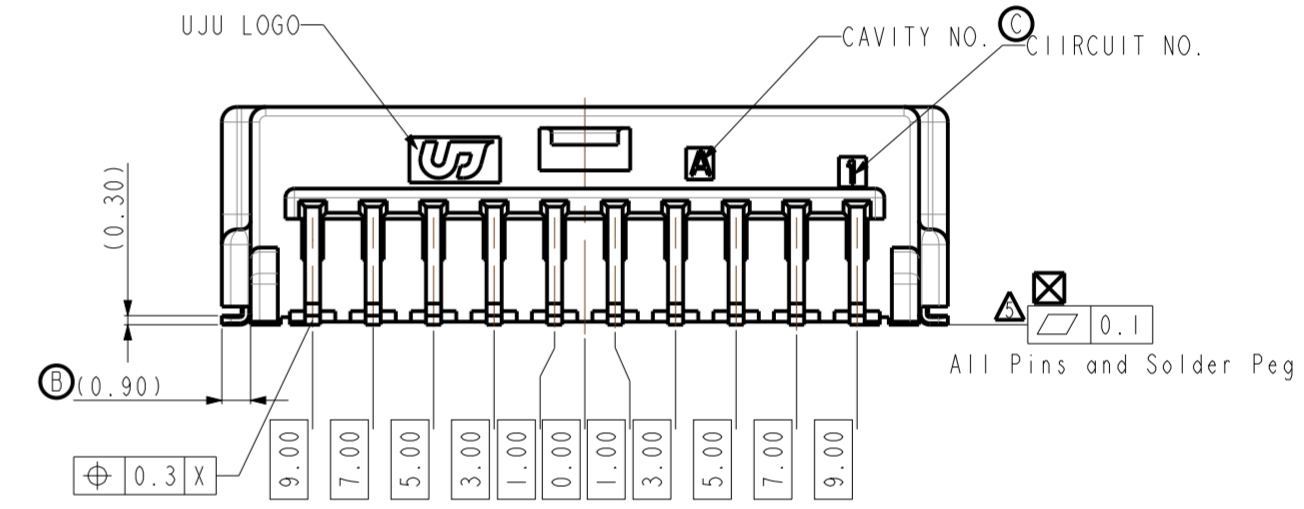
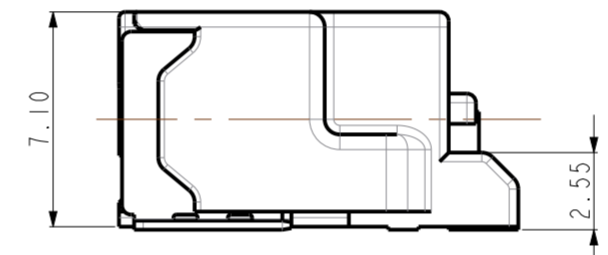

NOTE.

- GENERAL TOLERANCE : REFER TO DINI6742 T65 SPECIFICATION
- BURR 0.3 MAX.
- NO CRACK
- ALL LETTERS SHALL BE CLEAR AND LEGIBLE
- MEASURING THE DIMENSIONS OF TAB TML AND SOLDER PEG.
- FINISH TAB TML AND SOLDER PEG
TIN PLATING : 2.0~4.0um MATTE OVER NICKEL PLATING 0.8~2.0um MATTE
- PACKING : EMBOSS TAPE
- FLAMMABILITY : UL94 - HB
- VACUM GRIP AREA FREE OF BURR AND FECTOR PINS. MAX Ø8.0mm

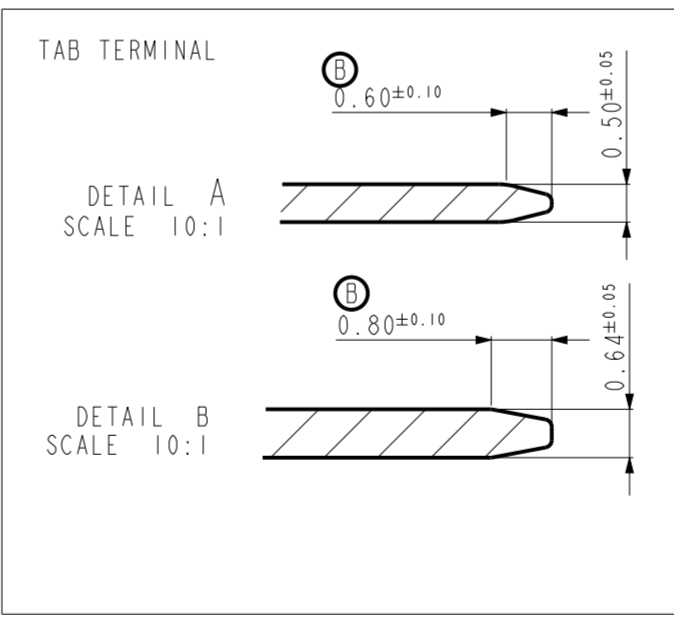

CODE A (NATURAL)

CODE B (BLACK)

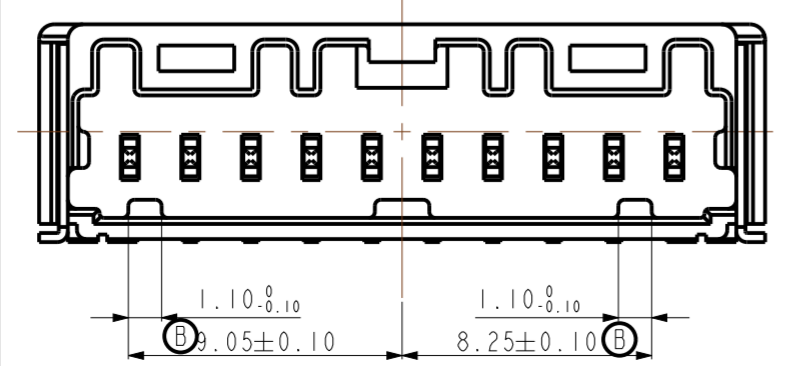
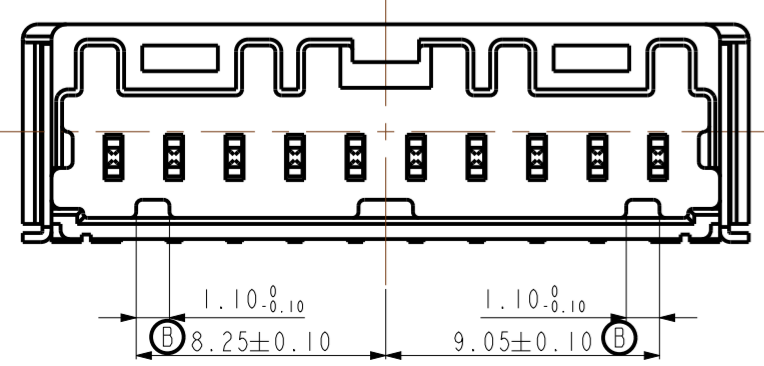

| NO | DESCRIPTION | MATERIAL | FINISH/COLOR | Q'TY |
|----|--------------------------------|-----------|--------------|------|
| ④ | 020 SMT SOLDER PEG-LEFT (HZT) | BRASS | POST-TIN | 1 |
| ③ | 020 SMT SOLDER PEG-RIGHT (HZT) | BRASS | POST-TIN | 1 |
| ② | 020 SMT TAB TML (HZT) | BRASS | POST-TIN | 10 |
| ① | 020_D_SMT_IOM_H_HSG_BK | PA9T GF30 | BLACK | - |
| ① | 020_D_SMT_IOM_H_HSG_NR | PA9T GF30 | NATURAL | - |

| | | | | |
|--|--|---------------------------|--|-----------------|
| CONTROL PRIORITY DIMENSION ■ CRITICAL ⊗ MAJOR □ MINOR | | DRWN DR KOO | (주)우주 일렉트로닉스 UJU Electronics co.,Ltd. | |
| TOLERANCES UNLESS OTHERWISE SPECIFIED 0 ± 0.0 ± 0.00 ± 0.000 ± 0.0000 ± ANGLES | | CHKD KH PARK | | |
| THIRD ANGLE PROJECTION | | APVD CY CHOI | DRAWING NO KH1810103 | |
| PRODUCT SPEC | | MATERIAL SEE TABLE | CUSTOMER | REV C |
| APPLICATION SPEC | | FINISH/COLOR SEE TABLE | DRAWING | SHEET 1 OF 1 |
| | | WEIGHT | LOC | SCALE A2 |
| | | | RESTRICTED TO | SIZE 4:1 |