

REV	REVISION RECORD	DATE	DRWN	CHKD	APVD
A	RELEASED	29 SEP '17	JK	CY	SJ
B	CHANGED	06 NOV '17	JK	CY	SJ
C	CHANGED	08 NOV '17	JK	CY	SJ
D	CHANGED	19 DEC '17	JK	CY	SJ
E	CHANGED	27 DEC '17	JK	CY	SJ
F	CHANGED	06 MAR '18	JK	SH	MJ
G	CHANGED (RD-2021-025)	25 FEB '21	JK	SH	MJ

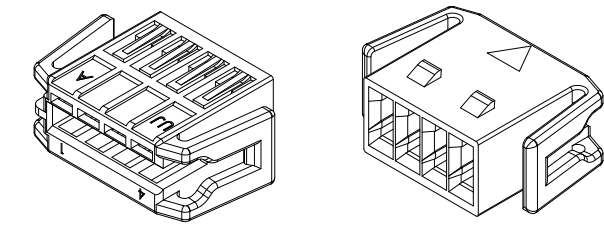

3D View

-NOTE 1. (Housing)-

1. General Tolerance : ±0.3
2. HSG Description : See TABLE 1.
3. Applicable Receptacle : See TABLE 2.
4. Optional Applicable T/CPA : See TABLE 3.(E)

TABLE 1.

PCB Slot 4F HSG	KH1600039-20	PA66-GF15	Black	White
	KH1600039-10		Natural	Black
Description	Part No.	Material	Finish / Color	Marking Color

DRWN JK. HWANG	 (주)우주일렉트로닉스 UJU Electronics co.,Ltd.		NAME	
CHKD KH. PARK			PCB Slot 4F HSG	
APVD CY. CHOI	MATERIAL	CUSTOMER		DRAWING NO
	SEE TABLE	DRAWING		KH1600039
	FINISH/COLOR	LOC	RESTRICTED TO	SIZE
	SEE TABLE			A3
PRODUCT SPEC	APPLICATION SPEC	WEIGHT	SCALE	SHEET
			3:1	1 of 1
				REV
				G

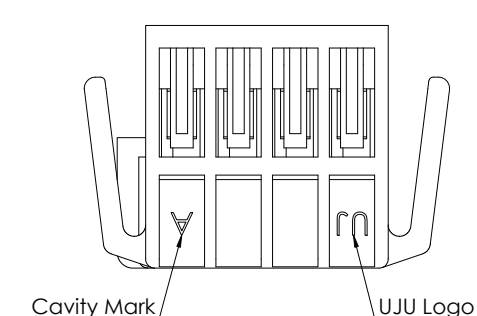
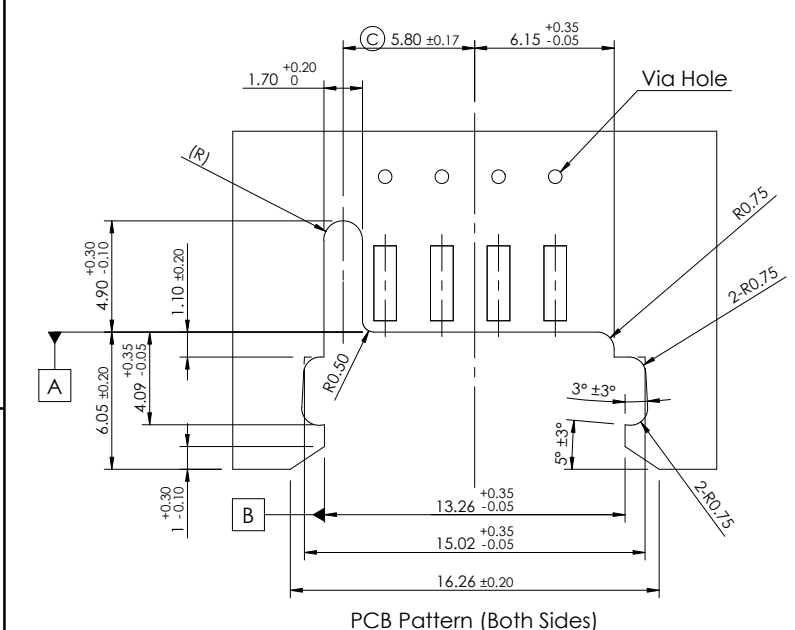
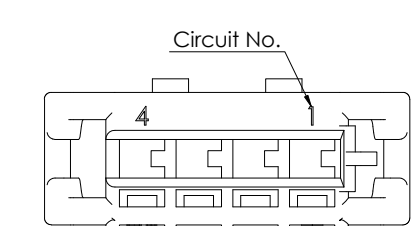
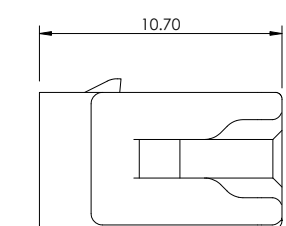
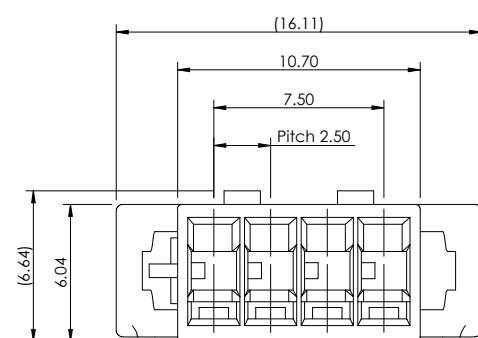
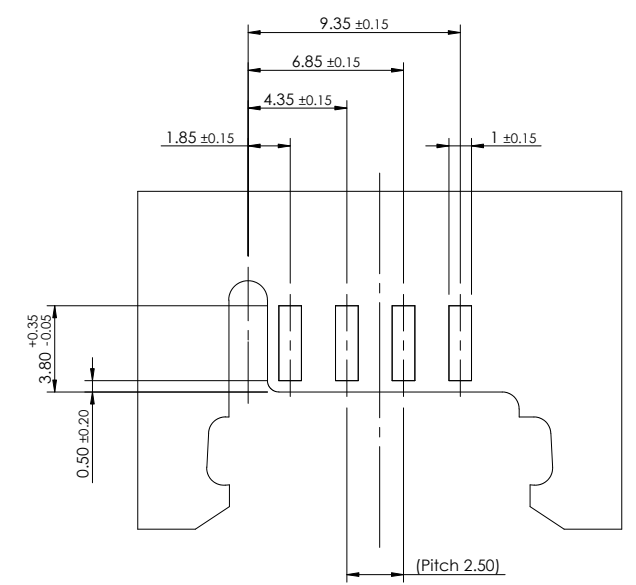
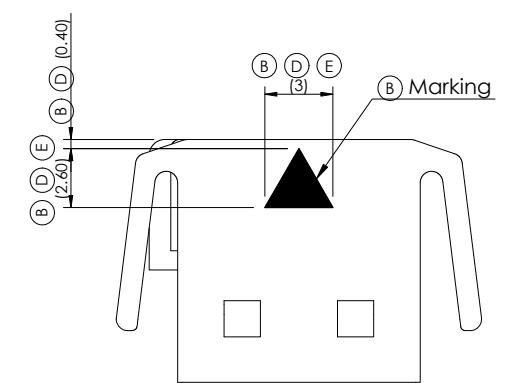
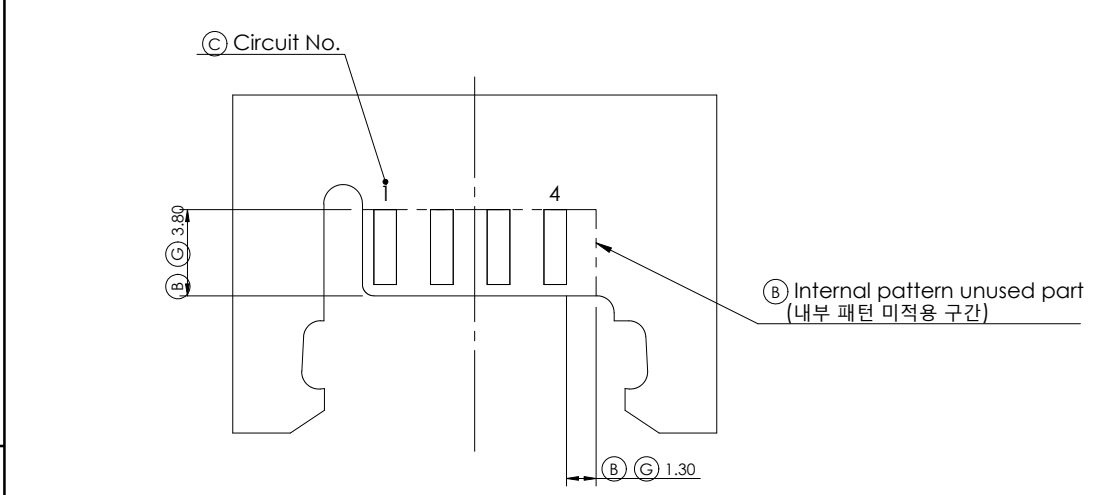

TABLE 2.

PCB Slot Rec.	KH1600036-21	Copper Alloy	Pre-Tin	0.3 ~ 0.5
Description	Part No.	Material	Finish	Wire Size (mm)

TABLE 3.(E)

PCB Slot 4F T/CPA	KH1700028-70	PA66-GF15	Green
Description	Part No.	Material	Color

-NOTE 2. (PCB)-

1. Thickness : 1.60 ±0.16
2. Finish : Same as terminal plating
Ex) Sn HASL↔Sn, Au↔Au
3. Recommendation : Apply a via hole for connect both sides.
4. Concrete specifications are discussed with UJU.